

OPTION #2

RECOMMENDED DESIGN

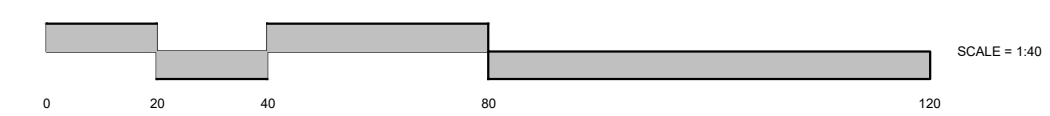
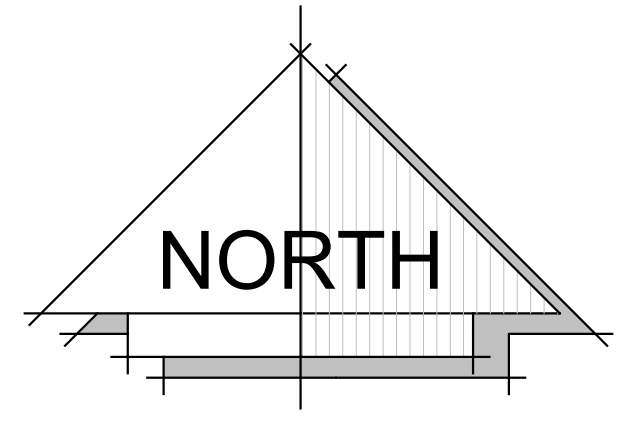
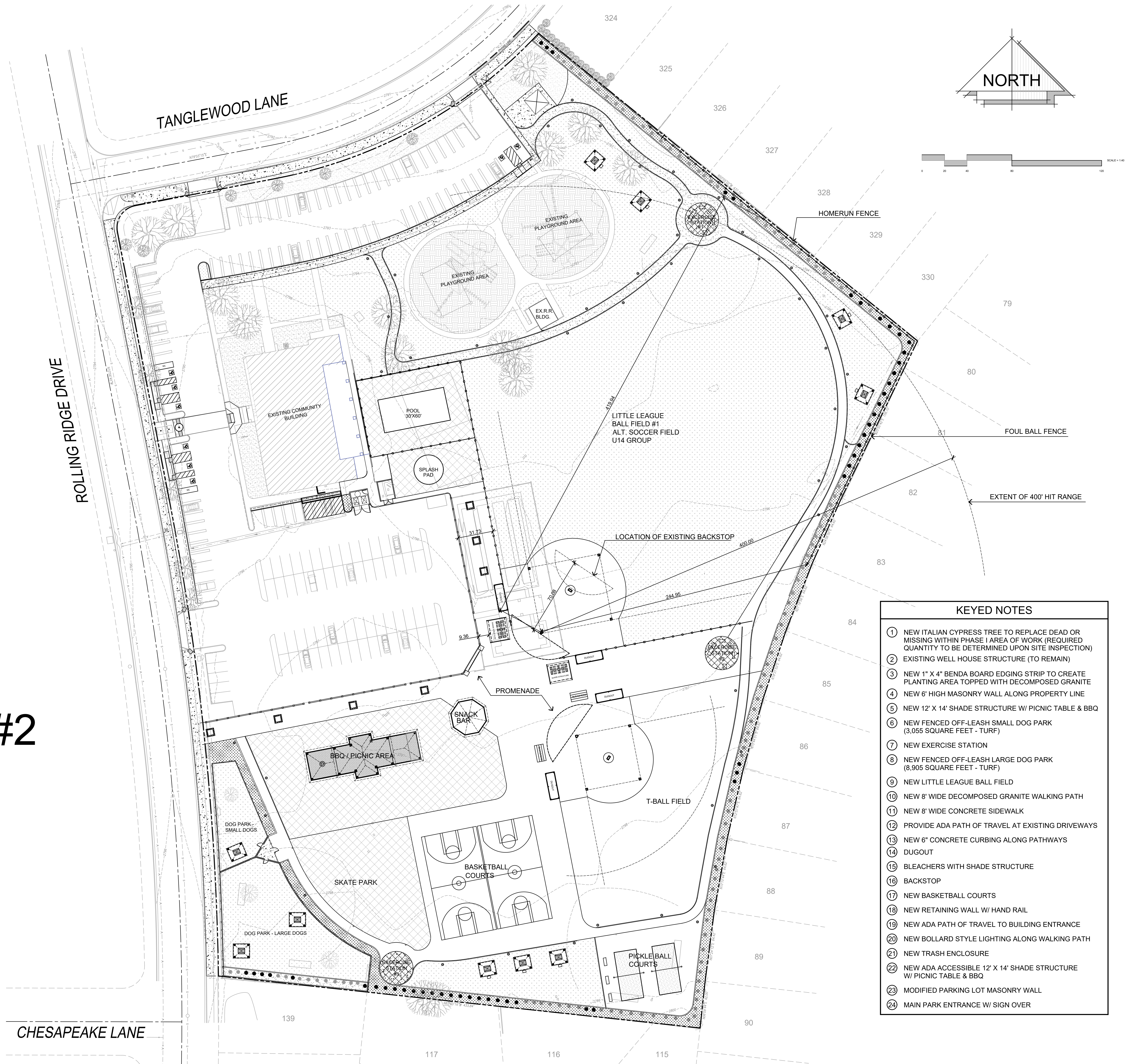

KEYED NOTES	
1	NEW ITALIAN CYPRESS TREE TO REPLACE DEAD OR MISSING WITHIN PHASE I AREA OF WORK (REQUIRED QUANTITY TO BE DETERMINED UPON SITE INSPECTION)
2	EXISTING WELL HOUSE STRUCTURE (TO REMAIN)
3	NEW 1" X 4" BENDA BOARD EDGING STRIP TO CREATE PLANTING AREA TOPPED WITH DECOMPOSED GRANITE
4	NEW 6" HIGH MASONRY WALL ALONG PROPERTY LINE
5	NEW 12' X 14' SHADE STRUCTURE W/ PICNIC TABLE & BBQ
6	NEW FENCED OFF-LEASH SMALL DOG PARK (3,055 SQUARE FEET - TURF)
7	NEW EXERCISE STATION
8	NEW FENCED OFF-LEASH LARGE DOG PARK (8,905 SQUARE FEET - TURF)
9	NEW LITTLE LEAGUE BALL FIELD
10	NEW 8' WIDE DECOMPOSED GRANITE WALKING PATH
11	NEW 8' WIDE CONCRETE SIDEWALK
12	PROVIDE ADA PATH OF TRAVEL AT EXISTING DRIVEWAYS
13	NEW 6" CONCRETE CURBING ALONG PATHWAYS
14	DUGOUT
15	BLEACHERS WITH SHADE STRUCTURE
16	BACKSTOP
17	NEW BASKETBALL COURTS
18	NEW RETAINING WALL W/ HAND RAIL
19	NEW ADA PATH OF TRAVEL TO BUILDING ENTRANCE
20	NEW BOLLARD STYLE LIGHTING ALONG WALKING PATH
21	NEW TRASH ENCLOSURE
22	NEW ADA ACCESSIBLE 12' X 14' SHADE STRUCTURE W/ PICNIC TABLE & BBQ
23	MODIFIED PARKING LOT MASONRY WALL
24	MAIN PARK ENTRANCE W/ SIGN OVER

STEENO
 DESIGN STUDIO INC.
 ARCHITECTURE • DESIGN • PLANNING
 11774 HESPERIA ROAD, SUITE B • HESPERIA, CA 92345
 PHONE (760) 244-5500 • FAX (760) 244-1948
 WWW.STEENODS.COM

DATE FINISHED
 AUGUST 2022

REVISIONS

THESE PLANS SHALL COMPLY WITH THE 2019 CALIFORNIA BUILDING CODE WHICH ADOPTS THE 2019 IBC, 2019 CBC, 2019 PEC, 2019 CEC, 2019 CFC AND THE 2019 ENERGY STANDARDS

THESE DOCUMENTS AND THE DESIGN AND IDEAS INCORPORATED HEREIN, AS AN INSTRUMENT OF A PROFESSIONAL SERVICE, ARE THE SOLE PROPERTY OF STEENO DESIGN STUDIO INC. ANY USE, IN WHOLE OR IN PART FOR WHICH THEY WERE NOT PROVIDED SHALL BE UNLAWFUL

PROJECT: MEADOWLARK PARK RENOVATIONS
SPRING VALLEY LAKE
 SHEET NO. 16
 DATE: 08/2022
 760.245.5756

JOB NO.
C16-127

SHEET NAME
OVERALL SITE PLAN

PAGE
A-0